

REGISTER



SLI Comprehensive Classes - Our Lady of the Lake School - Seattle, WA

Slingerland Summer Comprehensive Teacher Training Classes

July 27, 2021 - August 20, 2021 · Our Lady of the Lake Catholic School

REGISTER

2021 SUMMER COMPREHENSIVE CLASS AT OUR LADY OF THE LAKE CATHOLIC SCHOOL

The Slingerland® Approach Multisensory Structured Language Comprehensive Classes are based on an adaptation by Beth H. Slingerland of the multisensory approach of Dr. Samuel T. Orton and Anna Gillingham. The techniques she developed are based on sound neurological principles of learning and give children the necessary tools to be successful readers, writers and spellers.

The Comprehensive Classes are offered at three levels - introductory, second level and third level continuum. The classes are accredited through the International Multisensory Structured Language Education Council (IMSLEC). Each class includes a practicum with students, demonstrations and observations. This intensive class of study includes instructional techniques in handwriting, written language, decoding, and reading comprehensive.

The comprehensive classes are 133 classroom hours each and is approved for six graduate level extension credits through the University of San Diego. The credits are not part of a degree program and are at the option of the teacher/participant. Additional units or credit may be available through a local site.

Partial Scholarships may be available through your local IDA Branch.

In order to protect class participants and students alike, acceptance to a comprehensive class requires satisfactory completion of a criminal background and sex offender registry check. Forms for the background check will be provided in your registration confirmation email.

Discount pricing for comprehensive and short classes is available to Slingerland® Institute professional, lifetime and organization level members. Enter the discount code provided by the SIL Office.

We hope you can join us!

REGISTER

Non-discrimination Policy: SlingerlandSM Institute for Literacy admits students of any race, color, national and ethnic origin to all the rights, privileges, programs, and activities generally accorded or made available to students. It does not discriminate on the basis of race, color, national and ethnic origin in administration of its educational policies, admissions policies, scholarship and other programs.

Credit Card Service Charge: A 3% service charge is added to all registrations paid by credit card; check payments may show the service fee but please deduct that amount when submitting your check.

LOCATION

Our Lady of the Lake Catholic School, 3520 NE 89th St, Seattle, WA 98115

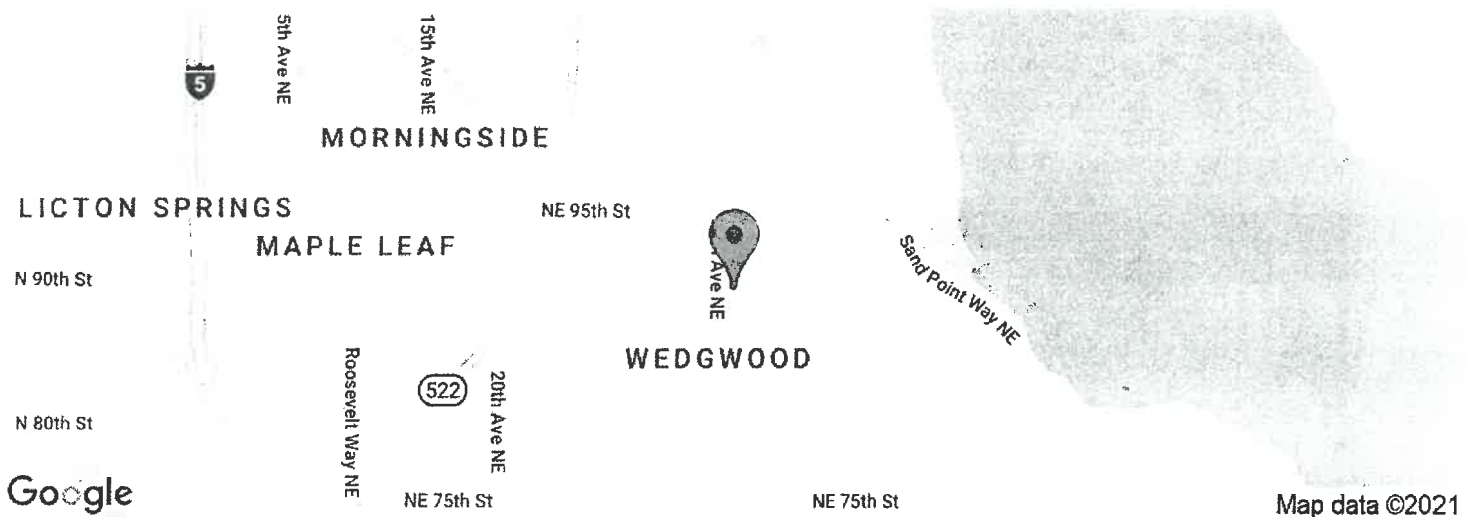

CLASS DESCRIPTIONS

INTRODUCTORY LEVEL

This class is the core of the Slingerland training program. It is traditionally offered as a four-week summer session and includes a practicum with students. It can also be adapted into a four to six week in-year class.

This class offers training in the etiology and diagnosis of specific language disability (dyslexia) and provides training in the techniques designed for a preventive and/or remedial program for classroom use.

Class Content Includes:

- Instruction in the introductory steps of handwriting, written language, decoding and reading comprehension
- Knowledge of the historical and philosophical background of Specific Language Disability (dyslexia)
- The study of phonic rules and their application to encoding and decoding
- The neurology of language as a means of developing oral language skills The history, philosophy and current research in the field of dyslexia
- The relationship of curriculum and classroom organization to the language arts program

REGISTER

CLOCK HOURS/CREDIT

Extension Credit/Units - Six (6) Continuing Education Units are available through the University of San Diego. The cost for the units are an additional fee paid directly to and through University of San Diego's enrollment platform. To register for graduate level extension credit through University of San Diego (USD), please follow the links below:

- [Click here for a direct link to the USD Introductory Level graduate level extension credit enrollment page](#)

****For USD graduate level extension credit, you must register ON or BEFORE the first day of the class you choose.**

CONTINUUM LEVEL CLASS

After a brief review of the basics in the introductory class participants will be introduced to and practice more advanced techniques in the language arts continuum. The use of the dictation paragraph and the screening procedures will also be presented.

Prerequisite: Satisfactory completion of the Introductory Level Comprehensive Class.

Class Content Includes:

- Guided observation of the evaluative and prescriptive elements imbedded in the daily plan ----Knowledge of how oral language skills relate to writing and reading skills
- Studying the vertical and horizontal use of the format for instruction
- How to integrate a new learning throughout the format
- Critical thinking skills needed for reading, writing and speaking
- Current research in all aspects of dyslexia
- How to administer and evaluate the Slingerland Screening materials

CLOCK HOURS/CREDIT

Extension Credit/Units - Six (6) Continuing Education Units are available through the University of San Diego. The cost for the units are an additional fee paid directly to and through University of San Diego's enrollment platform. To register for graduate level extension credit through University of San Diego (USD), please follow the links below:

- [Click here for a direct link to the USD 2nd Year Continuum Level graduate level extension credit enrollment page](#)

****For USD graduate level extension credit, you must register ON or BEFORE the first day of the class you choose.**

THIRD LEVEL CONTINUUM/INSTRUCTOR INTERN CLASS

This is a class designed for a limited number of participants wishing to become staff teachers in the Slingerland Training Class. The content encompasses all learning of the introductory and second year classes as the participant learns how to organize, maintain and evaluate a summer session, its students and teacher participants.

Prerequisite: Satisfactory completion of the Introductory Level and the Continuum Level Comprehensive classes; class instructor approval.

Participants may also enroll in the Third Level Continuum Class for more directed work with small groups of students. Daily lesson plans are developed to meet the needs of these students under the direction of the Slingerland Instructor.

Class Content Includes:

- The use of the Slingerland® Approach with a classroom group of children
- Evaluations of participant lesson plans, materials and teaching stations
- Evaluations of delivery of planned lessons Assisting with the completion of forms for the Slingerland® Institute
- Preparation and delivery of lectures to participants
- Preparation of an orientation about dyslexia and the Slingerland® Approach
- Individualized requirements assigned by the Instructor

CLOCK HOURS/CREDIT

Extension Credit/Units - Six (6) Continuing Education Units are available through the University of San Diego. The cost for the units are an additional fee paid directly to and through University of San Diego's enrollment platform. To register for graduate level extension credit through University of San Diego (USD), please follow the links below:

- [Click here for a direct link to the USD 3rd Year Continuum Level graduate level extension credit enrollment page](#)

****For USD graduate level extension credit, you must register ON or BEFORE the first day of the class you choose.**